

The Estate Agent People Recommend



6 St. Michaels Court,  
Ruscombe  
RG10 9UF

Price guide £270,000



Wentworth Estate Agents have great pleasure in offering to the market a TWO BEDROOM FIRST FLOOR APARTMENT located on a quiet cul de sac and within walking distance to Twyford village centre and Twyford mainline train station, serving London Paddington and Reading.

Also within walking distance is a local grocery shop, pharmacy and beautician. Polehampton Infant and Junior schools are also very close to the property.

Accommodation comprises of living room with electric fireplace and sliding doors to the balcony, kitchen with eye and base level units, electric hob, double oven, slim line dishwasher and fridge/freezer, two double bedrooms and family bathroom with WC, wash hand basin and bath with shower over.

Further benefits include, electric heating, mega flow system, double glazed windows, plenty of storage, loft storage, access to the shared garden, parking and a share of the freehold.

NO ONWARD CHAIN



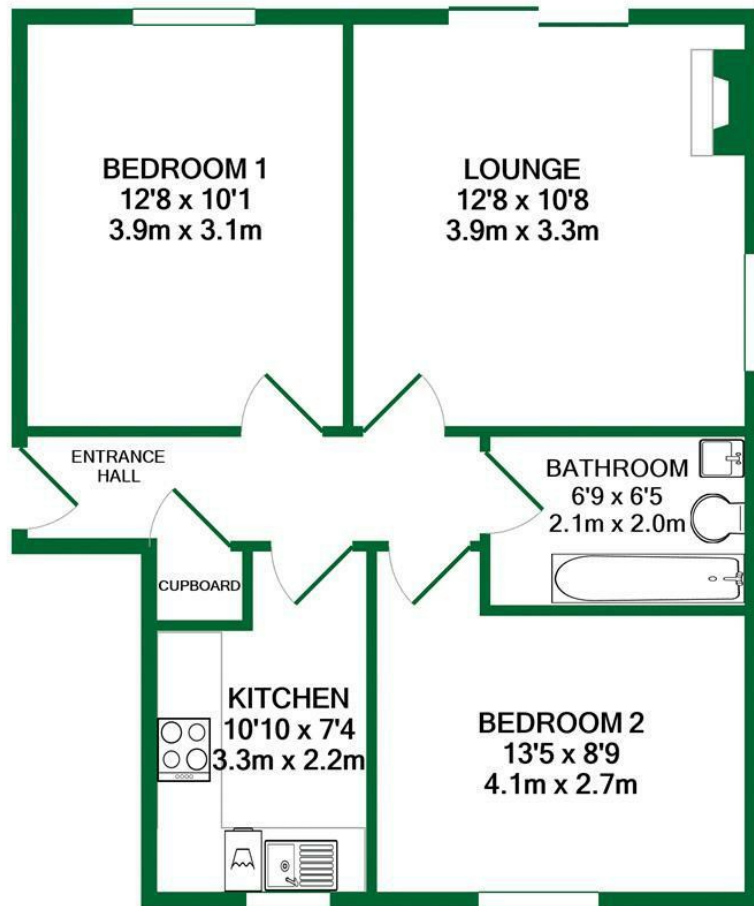

TOTAL APPROX. FLOOR AREA 565 SQ.FT. (52.5 SQ.M.)

Whilst every attempt has been made to ensure the accuracy of the floor plan contained here, measurements of doors, windows, rooms and any other items are approximate and no responsibility is taken for any error, omission, or mis-statement. This plan is for illustrative purposes only and should be used as such by any prospective purchaser. The services, systems and appliances shown have not been tested and no guarantee as to their operability or efficiency can be given

Made with Metropix ©2021

## ACCOMMODATION

- TWO BEDROOM FIRST FLOOR APARTMENT
- PARKING
- WALKING DISTANCE TO TWYFORD VILLAGE AND MAINLINE STATION
- FURTHER SHOPS ROUND THE CORNER FROM THE PROPERTY
- WALKING DISTANCE TO POLEHAMPTON JUNIOR AND INFANT SCHOOLS
- PLENTY OF STORAGE
- SHARE OF THE FREEHOLD
- NO ONWARD CHAIN



The Old Butchers, 15 High Street, Twyford, Berkshire, RG10 9AB  
t: 0118 934 0027 e: twyford@wentworthea.com

IMPORTANT: we would like to inform prospective purchasers that these sales particulars have been prepared as a general guide only. A detailed survey has not been carried out, nor the services, appliances and fittings tested. Room sizes should not be relied upon for furnishing purposes and are approximate. If floor plans are included, they are for guidance only and illustration purposes only and may not be to scale. If there are any important matters likely to affect your decision to buy, please contact us before viewing the property.



wentworthea.com



wentworth\_ea



wentworthestateagents